

RERA Registration Number
RAJ/P/2023/2879
www.rera.rajasthan.gov.in

A Project by :



VATSAL GROUP
Building Happy Homes

SPACE7

Retail | Offices | Food & more...

*Elevated spaces to
upscale your success*

“A RISING
NEW STAR
AT THE
HEART OF
THE CITY”

Space 7 is a newly established commercial hub situated in a prime location on Shipra Path, Mansarovar. Enhance your shopping experience or drive your business towards success at Space 7. This quality-constructed space is well-ventilated and provides ample natural lighting. Whether you're an entrepreneur or managing a growing business, Space 7 is the ideal place to chase your dreams.



Prime
Location



Shopping
Destination



Corporate
Offices



Roof Top
Restaurant
and Cafe

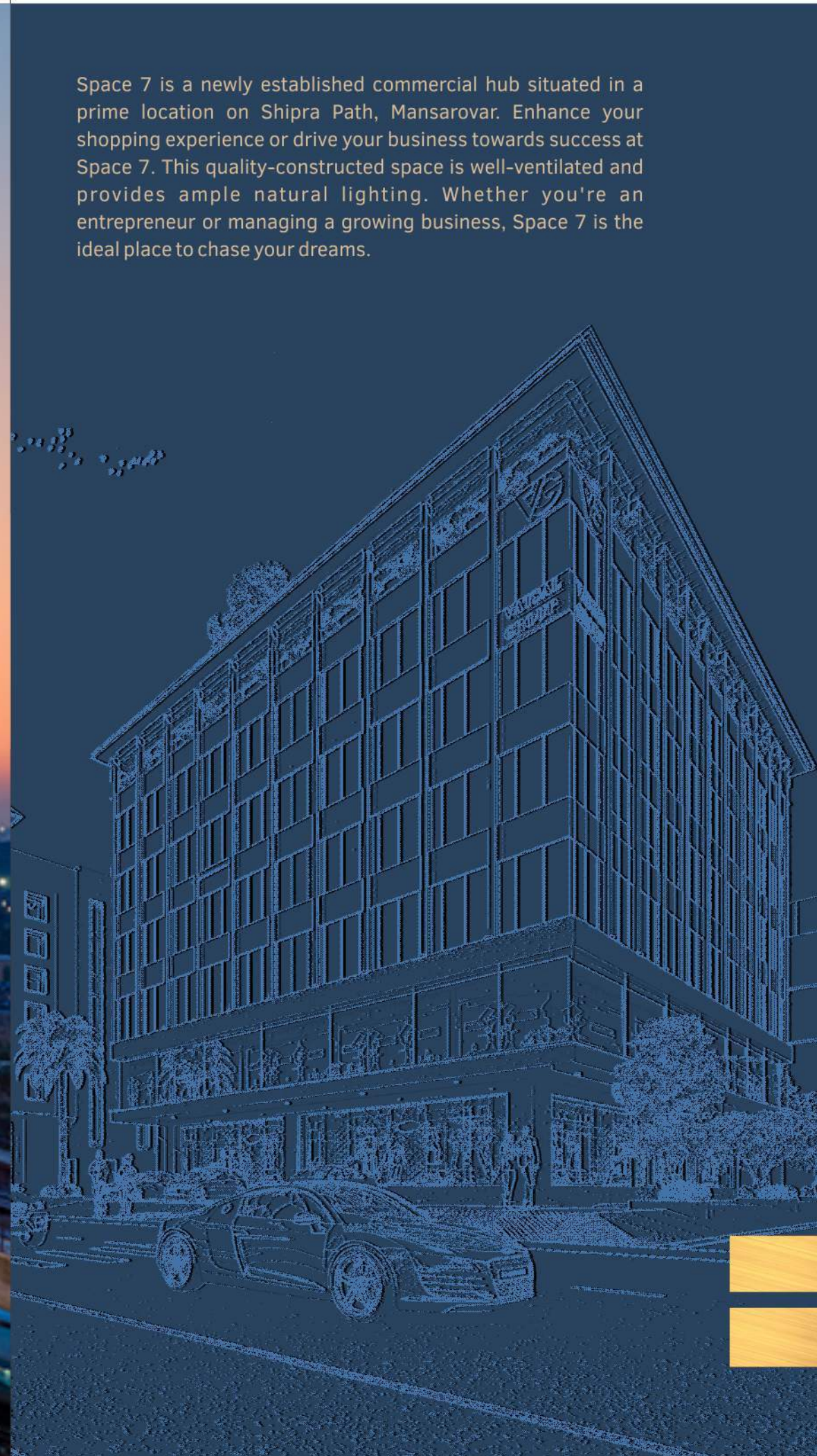
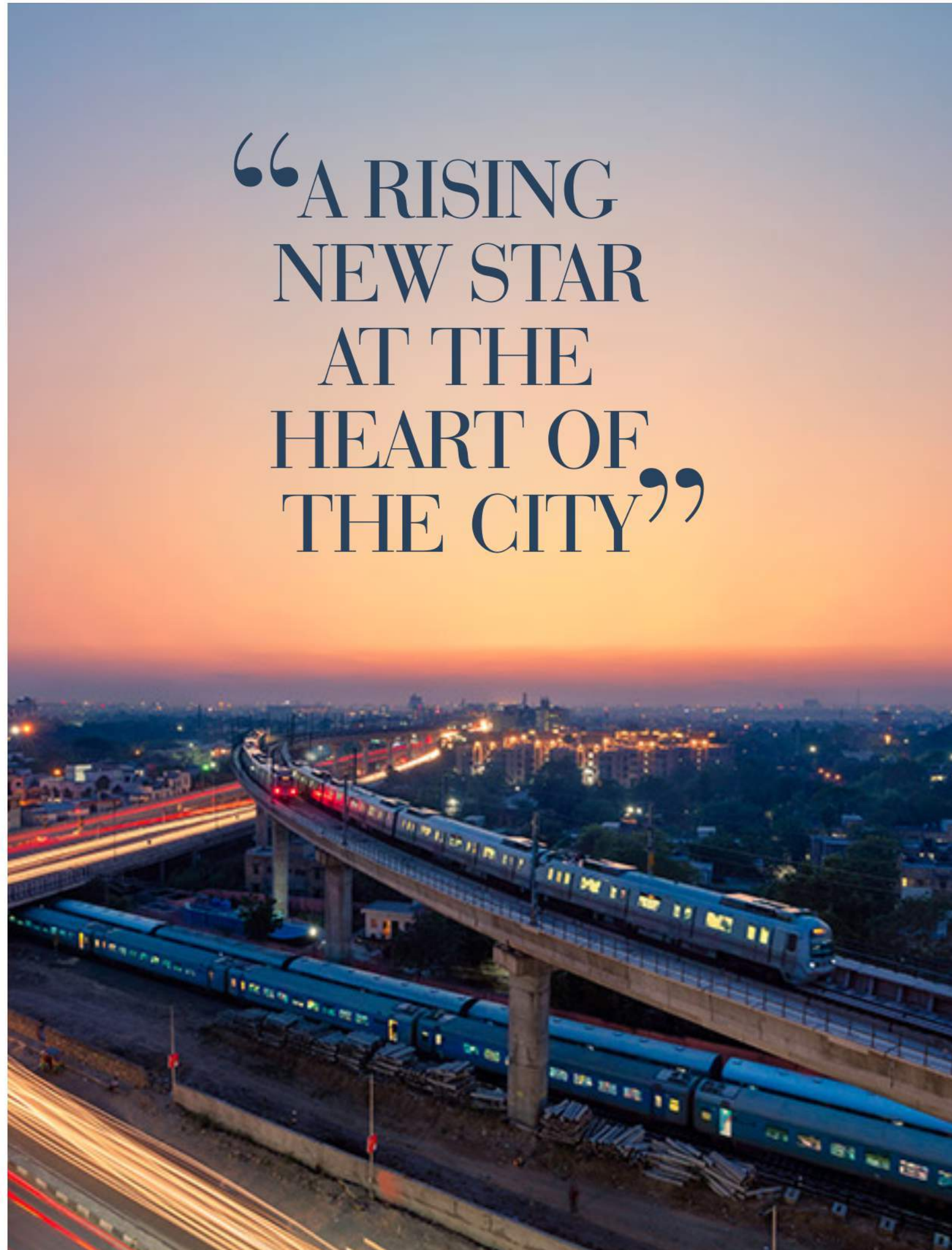

*An address that attracts
people from all over the place*



SPACE7

Retail | Offices | Food & more...

Site : Plot No. 7/C-02A (Corner), Shipra Path, Mansarovar, Jaipur, Rajasthan



*A shopping fun
that you deserve*

Shopping Destination



Explore limitless style
for an unparalleled
shopping journey

Space 7 offers a one-of-a-kind shopping experience. Immerse yourself in a world of luxury and diversity, with selected settings that appeal to both fashion fans and trendsetters. From stylish boutiques to iconic retailers, find the pinnacle of style, refinement, and convenience. Elevate your shopping therapy with the ideal combination of ambiance, carefully selected collections, and exceptional service.



SHOPPING

*Crafted to lead
your success story*



CORPORATE OFFICES

Unleash potential in the redefined corporate spaces

Space 7 is the pinnacle of corporate excellence, where businesses thrive and ideas grow. Our thoughtfully designed office spaces are more than simply workspaces; they are vibrant centers built for success. We are redefining the corporate experience with modern amenities and flexible workplaces. Immerse your team in a culture that values collaboration, creativity, and productivity.





A lively rooftop dining experience to elevate your taste palette

Escape to new heights of gastronomic enjoyment with our rooftop dining experience. Enhance your eating experience with panoramic vistas, cool breezes, and an outstanding menu designed to excite your taste buds. Our rooftop retreat is more than simply a meal; it's an experience beyond the ordinary. Savor moments beneath the open sky as our chefs create a symphony of flavors, making every meal a celebration.



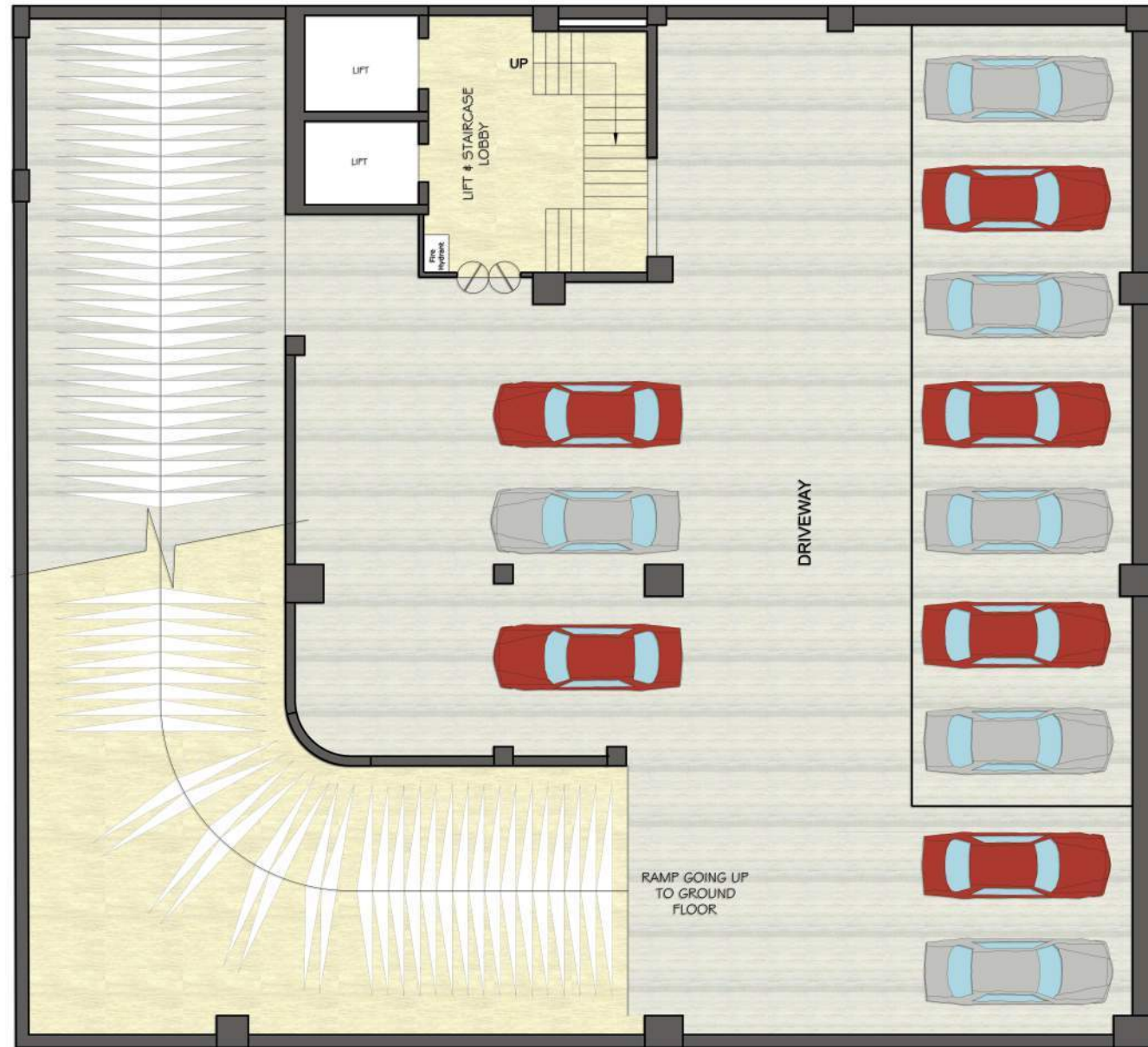

BASEMENT FLOOR PLAN



STILT FLOOR PLAN

| Office | Built up Sq.ft. | Carpet Sq.ft. | Saleable Sq.ft.(50%) |
|--------|-----------------|---------------|----------------------|
| G-01 | 5000.00 | 4784.22 | 7500.00 |





FIRST FLOOR PLAN



TYPICAL FLOOR PLAN

| Office | Built up Sq.ft. | Carpet Sq.ft. | Saleable Sq.ft.(50%) |
|--------|-----------------|---------------|----------------------|
| 101 | 6938.83 | 6749.73 | 10408.25 |

| Office | Built up Sq.ft. | Carpet Sq.ft. | Saleable Sq.ft.(50%) | Office | Built up Sq.ft. | Carpet Sq.ft. | Saleable Sq.ft.(50%) |
|---------|-----------------|---------------|----------------------|---------|-----------------|---------------|----------------------|
| 201-501 | 376.10 | 351.80 | 564.15 | 207-507 | 466.70 | 439.60 | 700.05 |
| 202-502 | 370.50 | 351.80 | 555.75 | 208-508 | 491.00 | 469.05 | 736.50 |
| 203-503 | 372.75 | 354.00 | 559.13 | 209-509 | 491.00 | 469.05 | 736.50 |
| 204-504 | 480.80 | 453.85 | 721.20 | 210-510 | 460.80 | 439.60 | 691.20 |
| 205-505 | 426.10 | 399.65 | 639.15 | 211-511 | 459.55 | 439.60 | 689.33 |
| 206-506 | 486.20 | 457.05 | 729.30 | 212-512 | 873.50 | 828.47 | 1310.25 |





SPACE7

Retail | Offices | Food & more...

Features



Showroom



Offices



3 Side Road



System Elevation



Food Court



Lounge



High-speed Elevators



CCTV Surveillance



Fresh Environment



Spacious Parking Space

Specifications

EXTERIOR

- ⊙ Large Entrance Lobby
- ⊙ Combination of Painted/Glass Surfaces
- ⊙ System Elevation
(Technal /SCHUECO or Equivalent)

VERTICAL CIRCULATION

- ⊙ Lift 2 Nos. including service lifts connecting all floors

POWER BACK-UP

- ⊙ 100% Power Back-up for Common areas/service.

COMMON FACILITIES

- ⊙ Well appointed Public Toilets

SECURITY

- ⊙ 24 Hours Security with Latest Security Devices

ELECTRICAL

- ⊙ Provision for Data cable at single point
- ⊙ Electrical Cable at single point
- ⊙ Provision of AC at single point



Vatsal Group is a leading Building & Construction Company in Jaipur that has executed construction work for some of the most significant projects in the city.

We believe in quality, not in quantity. We are known for perfection. When we plan to start a new project, we look at three things location, location & only location. We aren't selling property, we try to understand the need of people and fulfill the same with quality work. A smiley face of the customer with satisfaction is our priority.

The majority of people in India looking for a dream home. And they put their blood sweat earnings to get it. We try to put all our experience & efforts to provide a high level of satisfaction beyond their expectation when people are planning to buy a home. We don't have any right to break people's dreams, so we try to help them to achieve their dream by providing quality work. "Vatsal Group" respects the expectations and emotions of every people that they have while looking for their dream home.

Our Other Projects



The Elysian, Swej Farm



Utopia, Tilak Nagar



Jubilant, Mansarovar



Libra Residency, Vaishali Nagar



Kavyam, Lal Kothi



Mahaveer Residency, Vidyut Nagar



G-15, Vidhayak Nagar, Lalkothi, Jaipur, Rajasthan 302005
Website: www.vatsalgroup.com | Email: groupvtsal@gmail.com

Call : **9024 185 185**

Disclaimer: This Brochure is purely conceptual and not a legal offering. Further the Promoters/Architect reserve the right to add/delete/ modify any details/specifications/elevation mentioned here in.